

K
↓

自锁状态

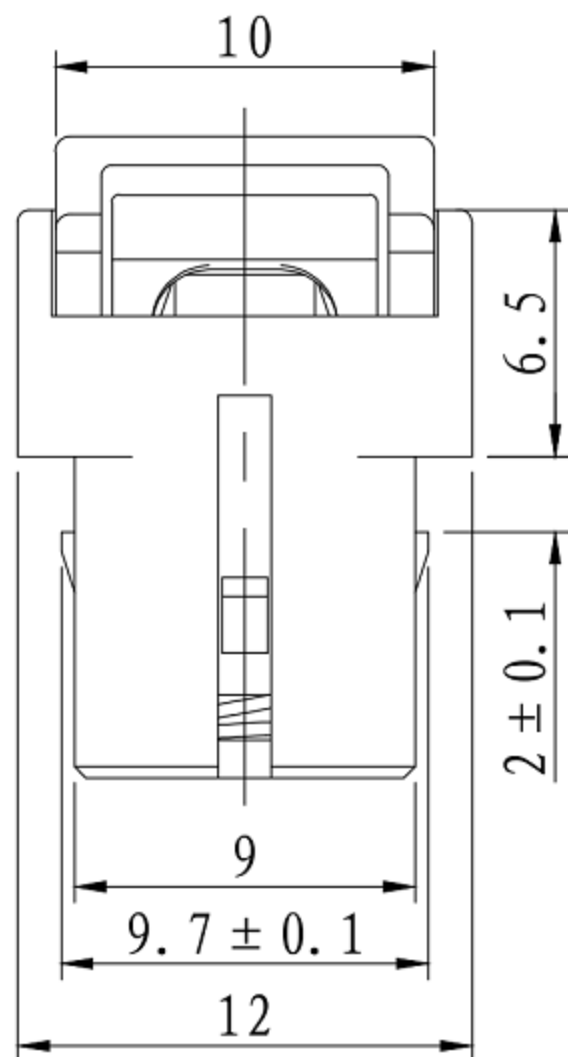
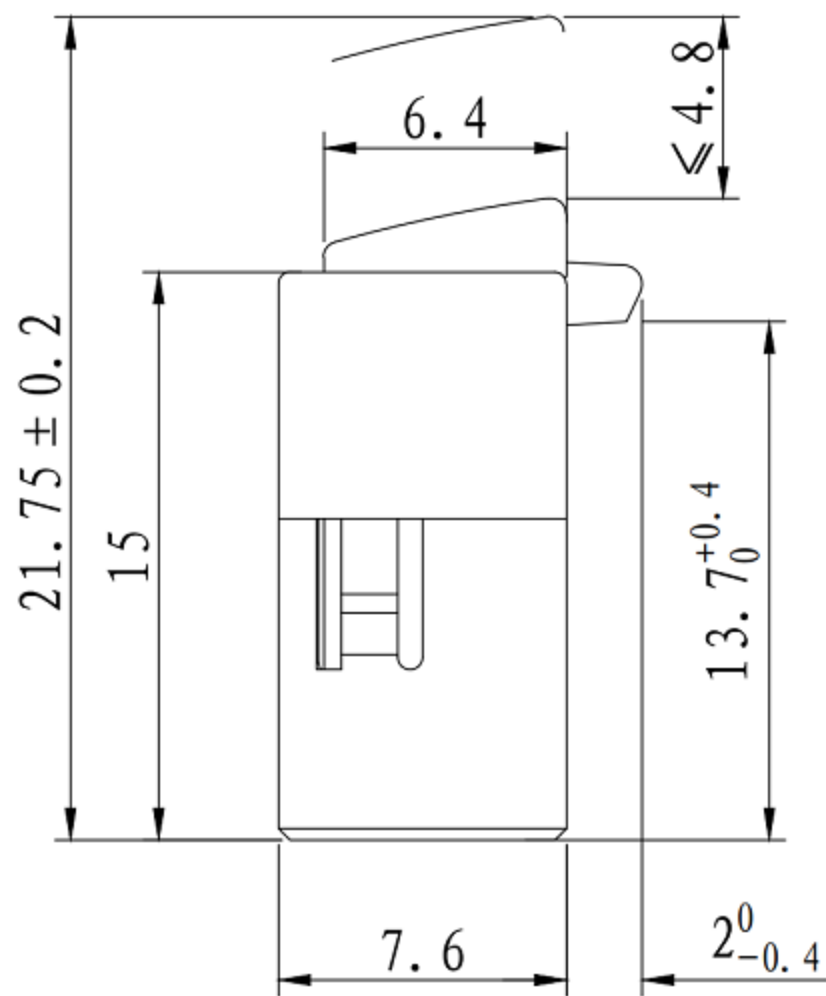

技术要求

1. 总行程: 6 ± 0.3 mm, 自锁行程 ≤ 4.8 mm, 解锁行程 1.2 ± 0.3 mm;
2. 按钮能承受K方向的力最大100N/1min;
3. 使用环境温度 $-20^{\circ}\text{C} \sim 80^{\circ}\text{C}$;
4. 操作力300-600gf;
5. 沿着K方向开关操作寿命大于1万次;
6. 开关档位应灵活, 档位清晰、手感无卡滞, 复位可靠;
7. 塑料件色泽均匀, 无严重毛刺、划伤、收缩、破损等缺陷;
8. 未标注公差按以下执行:
 $x. \pm 0.30$. $x \pm 0.20$. $xx \pm 0.10$ $\angle \pm 2^{\circ}$.

TITLE	DOOR LATCH SWITCH	DRAWN		TOLERANCE OTHERWISE UNLESS SPECIFIED	8					
PART NO.	Lock switch	CHECKED		UP TO 5	± 0.2	6				
DRAW NO.	GD-PR-19	APPROVED		ABOVE 5 ~ 30	± 0.3	5				
SCALE: 2:1	UNIT: mm	DATE:		ABOVE 30 ~ 50	± 0.4	4				
				ABOVE 50	± 0.5	3	SPRING	SUS	1 Ni PLATED	
				ANGLE	$\pm 3^{\circ}$	2	HOUSING	POM	1 BLACK	
						1	SLIDER	PA12	1 BLACK	
						NO.	PARTS	MATERIAL	QTY. FINISHING	
東莞市高迪電子有限公司							DONG GUAN GAODI ELECTRONICS CO., LTD.			